



MADE IN CHINA

HLLPRO

Shenzhen Hengyehui Technology Co., Ltd.

USER MANUAL

Wireless Car Charger



**Strong
Magnetic Force**



**Fits
All Phones**



**Compatible
with MagSafe**

Contents

| | |
|---------------------------------|----|
| Specifications | 01 |
| Overview | 02 |
| Installation Instructions | 05 |
| Using Steps | 10 |
| Attentions | 13 |
| Customer Service | 15 |

Thank you for purchasing and using this product!

In order to bring you a better experience, please read this operation instruction carefully before using this product and keep it properly for future reference.

Specifications

| | |
|--------------------|-------------------------------|
| Product Name | Magnetic Wireless Car Charger |
| Model | CD-W11C |
| Material | Aluminum Alloy+ABS |
| Applicable Place | Car CD Slot/Dashboard |
| Charging Interface | Type-C |
| Temperature | 32°F-104°F |
| Input Voltage | 5V/9V/12V |
| Input Current | 2A-2.1A |
| Output Power | 5W/7.5W/10W/15W |

The parameters above are derived from the laboratory of OHLPRO. The actual parameters may differ from product to product or other factors. All images shown here are for reference only.

Overview

Standard

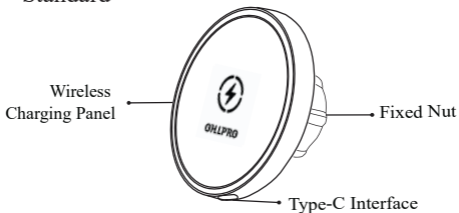

Magnetic Ring
(Single-use not reusable)

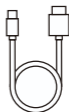

Charging Cable (1M)



Instructions



Match-up Card

Optional

A - CD Slot Mount

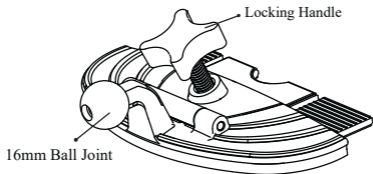

B - 3M Adhesive Base



Rotating the Locking Handle can adjust the tightness inside the CD slot.

①

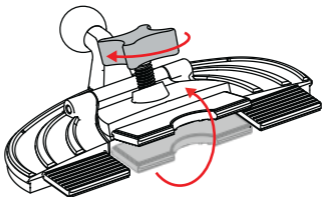

②

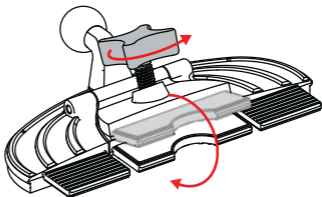

Installation Instructions

Use with A - CD Slot Mount

1. Assemble as shown.

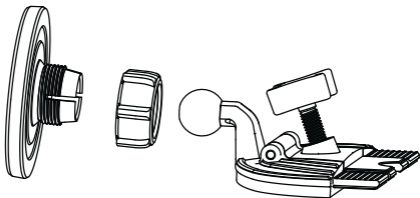

2. Push the ball joint firmly into the groove on the back of the CD slot mount then tighten the fixed nut.

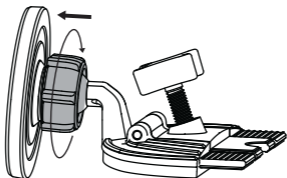

3. Insert the holder into the car's CD slot and turn the Locking Handle clockwise to lock the holder in the slot.

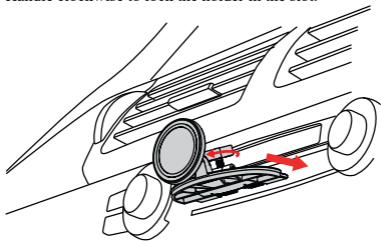

4. Stick the magnetic ring on the back of your phone and start using it.

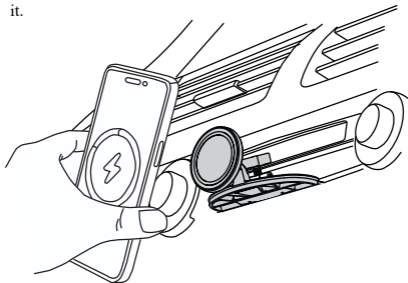

Suitability of CD Slot Mount

Mount only supports CD slot, not car air vents, dashboards, windshields, curved CD slots, etc.

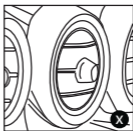
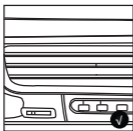
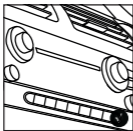
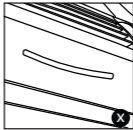
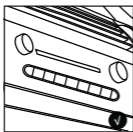

Note: When installing the CD slot mount, please pay attention to the force of adjusting the knob to avoid damaging the car's CD slot.

Use with B - 3M Adhesive Base

1. Push the ball joint firmly into the groove on the back of the car mount then tighten the fixed nut.

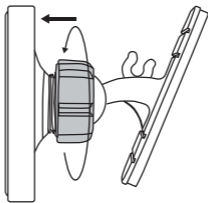

2. Use a wet wipe to clean the area where the car mount needs to be attached, wait for it to dry.

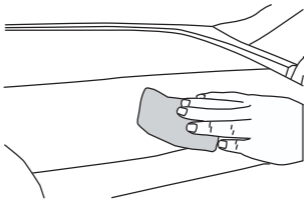

3. Remove the protection paper of 3M adhesive from the base of the mount.

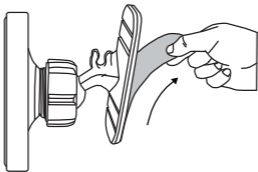

4. Attach and press firmly the base on the cleaning area. Please let it stand for 1 day to achieve maximum adhesion. Adjust the angle of the car mount to fit your sight.

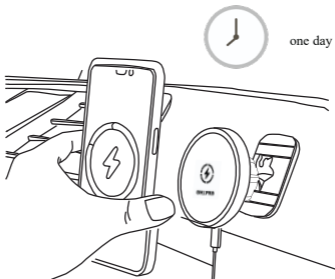

Using Steps

The magnetic car phone charger mount shall be used in the following 3 usage conditions, Please choose the corresponding usage according to the model of your mobile phone.

- ① iPhone 16/15/14/13/12 series mobile phone:

Direct magnetic attraction is OK

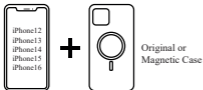
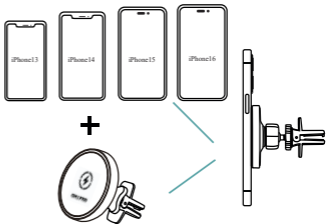

Original or
Magnetic Case

- ② iPhone 16/15/14/13/12 series with original or magnetic case:
Direct magnetic attraction is OK



- ③ Other situations (iPhone 16/15/14/13/12 series with non-original non-magnetic case, or non-iPhone 16/15/14/13/12 bare machines/ phone with a mobile phone case):It shall be used by matching up with metal rings.
-

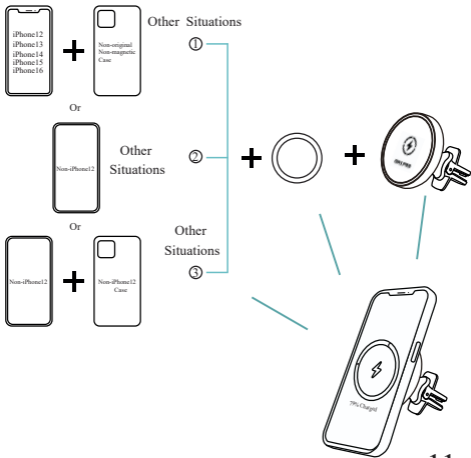

Assembling the Metal Ring

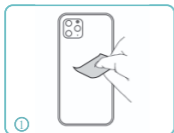

Use a cleaning wipe to clean the back of the phone (or phone case) where the metal ring needs to be posted.

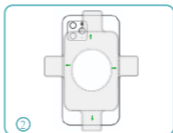

Take out the pairing card and fix it on the edge of the phone /back of the phone

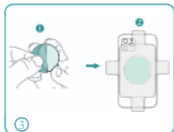

Remove the protective cover of the transparent sticker, aim it at the half-circle of the match-up card before pasting it on the back of the phone(or phone case)

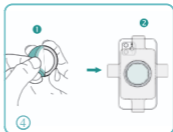

Tear off the protective paper of the metal ring and paste the metalring onto the transparent sticker.



Press firmly along the metal ring to secure it.

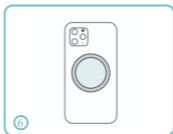







Remove the match-up card and the installation is completed

Attentions

- 1 . When using this product, please use an adapter with an out- put of 12V or compatible with QC 3.0 PD 2.0 quick charging function. Without this parameter car adapter can not guarantee the normal fast charging of cell phones.
- 2 . No metal objects, such as iron sheets, rings, and metal protective coverings, can be placed on the contact surface during charging. which would affect the adsorbing effect.
- 3 . Please make sure you are using the iPhone 16/15/14/13/12 series MagSafe cases.It is can't compatible with Non-MagSafe cases.Non -MagSafe cases make the magnetic force weak and can't charge.
- 4 . Your phone must have magnetic attraction and wireless charging, otherwise it will not work properly.
- 5 . This product has the function of input over current and over voltage protection. The improper use will shut down or reduce the output power. Please check whether the device is abnormal or improperly used.
- 6 . Keep the operating ambient temperature at 32-104°F, do not place the product in water and fire, and the environment- ts with too high (>104°F)and too low(<32°F)temperature.

- 7 . To better protect your phone, it is recommended that you paste the metal ring on the back of the phone case.
- 8 . Please do not disassemble.
- 9 . Please install the car mount in a suitable place before starting the journey, do not operate and adjust the car mount while driving.
- 10 . Do not install the car mount in places that interfere with the airbag or driving.
- 11 . Keep the car mount away from children.
- 12 . Incorrect use or improper placement of the product by the user may lead to a reduction in the service life of the product or damage to the product. The consequence thus incurred is not within the scope of the warranty or the manufacturer's responsibility. We hope you can kindly understand.

Customer Service

-  24-months limited warranty
-  Lifetime technical support
-  support@ohlpro.com
-  service@ohlpro.com
-  office@ohlpro.com
-  @OHLPRO
-  <https://ohlpro.com>

If you have any questions or concerns about our products, please feel free to contact us. We'd be more than happy to help and answer you. Thank you for your attention and support of our products, and we are looking we look forward to establishing good cooperative relationship with you.



MADE IN CHINA

Visit Our Store for More Products!

Just scan & discover!



Shenzhen Hengyehui Technology Co., Ltd.

Address: Xinmu Community, Pinghu Street, Longgang District, Shenzhen, No. 1 Building, Building 1, Area A, Zhanmiling Industrial Zone

Business cooperation: support@ohlpro.com

Website: <https://ohlpro.com>

Shenzhen Hengyehui Technology Co., Ltd. All Rights Reserved.